

MOUNTING HOLES
6 HOLES Ø8.15/8.05
EQUISPACED ON A 200.025 P.C.
MIN C/BORE Ø17.0

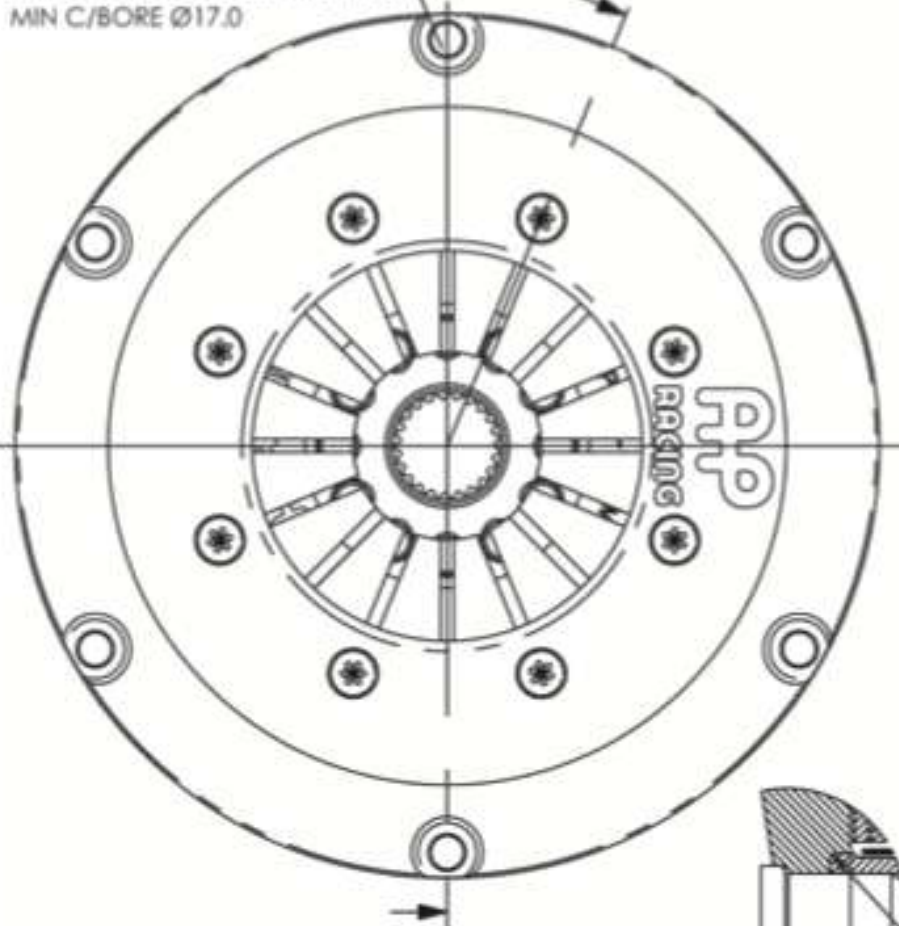

NOTE A:
RELEASE TRAVEL TO BE LIMITED
TO 5.50mm MAXIMUM BY MEANS OF
EXTERNAL STOP.

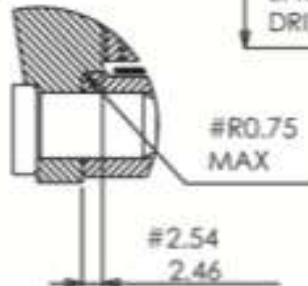

SET UP HEIGHT WORN
SEE SPECS ABOVE
(0.75 WEAR IN)

SET UP HEIGHT NEW
SEE SPECS ABOVE

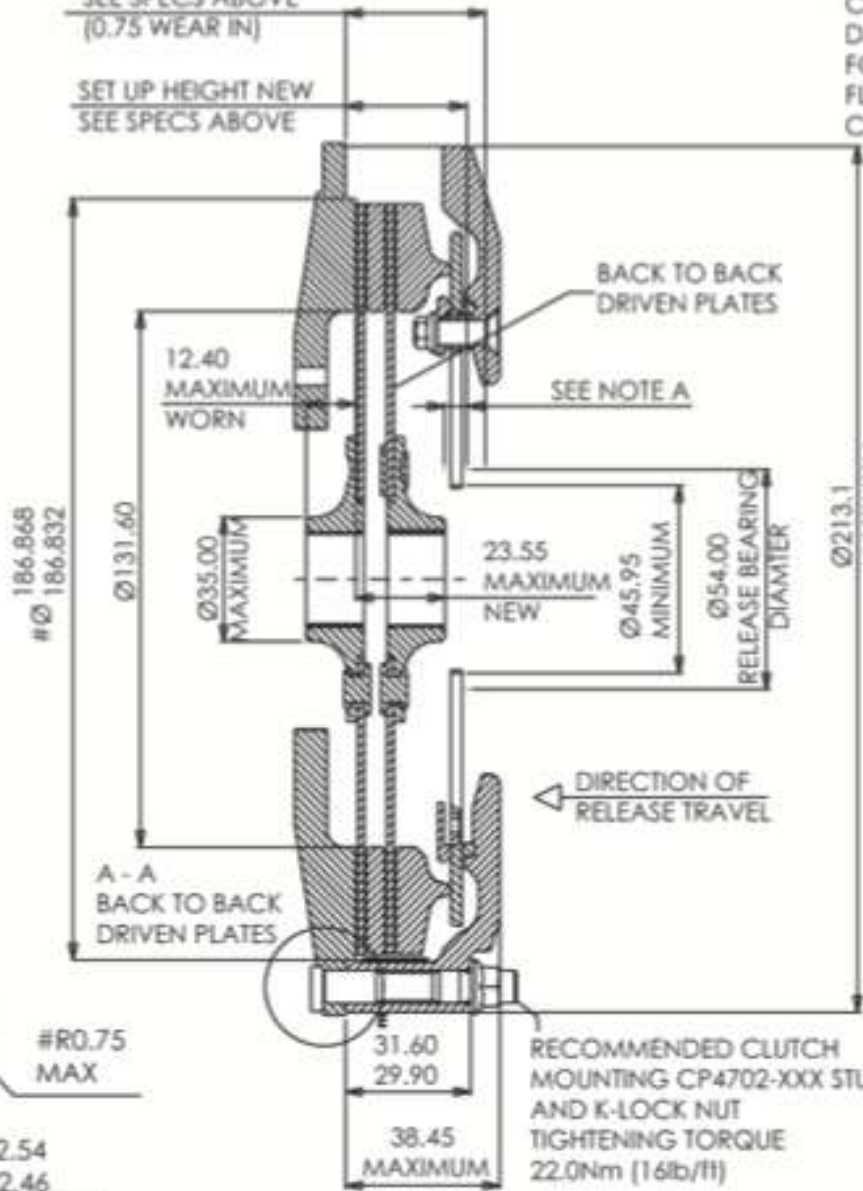

CP2567 TYPE
DRIVEN PLATES
FOR INCREASED
FLYWHEEL BOLT
CLEARANCE

